

TempTale® Ultra BLE

Getting Started Guide

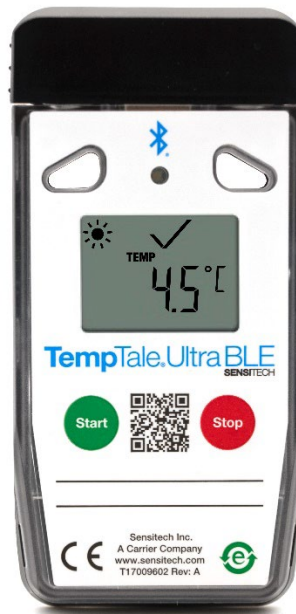

For a full-size printout of this Guide, go here: <https://www.sensitech.com/en/support/user-manuals/>
Min. System Requirements • iPhone 7 or higher running iOS 11+ • Android 7.1+ • Samsung Galaxy 8+
Tech Support sensitech.support@carrier.com or EMEA: +31 (0)252 211 108 or Hong Kong: +852-2880-0389

1. On the smartphone, from the Apple Store or Google Play store, download and install the TempTale® App 3.1 (see *figure 5*).
2. Open the TempTale® App; allow the app access to the smartphone Bluetooth (tap OK).

3. – Tap Get Started.

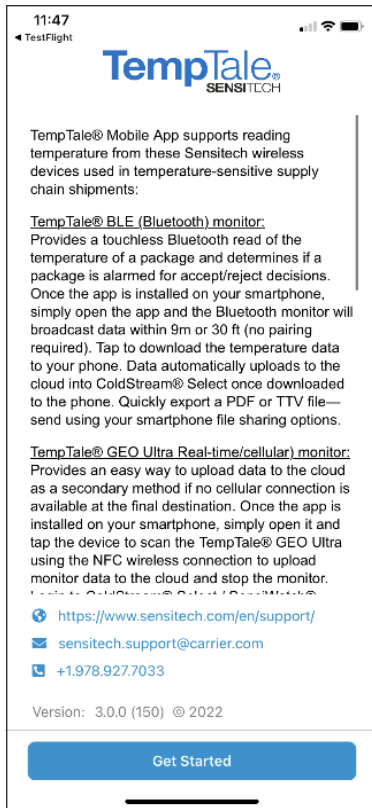

4. – Tap both I accept options then tap I Agree.

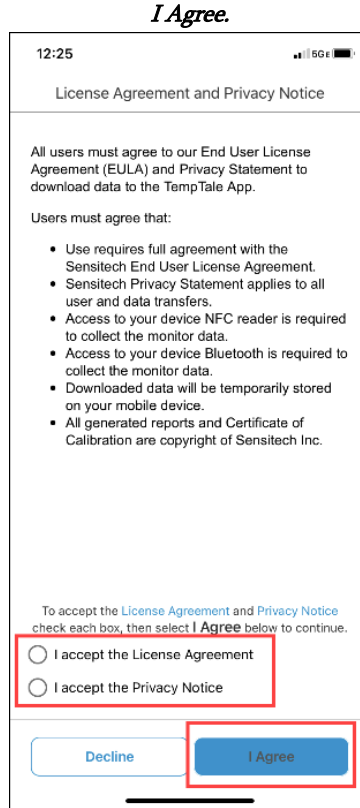

5. – Complete and Save User Profile.

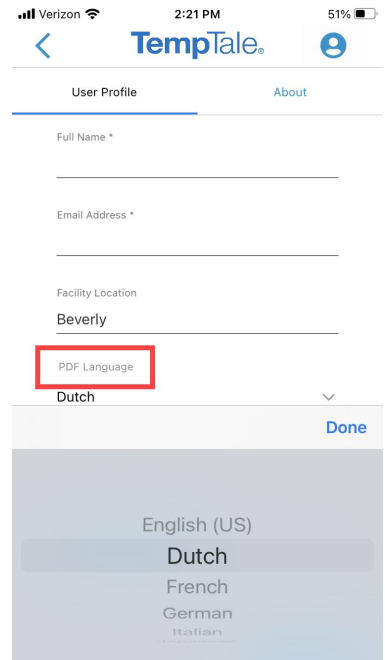

Note: You can select the type of language you want when you download data to a PDF. Set the PDF Language in the User Profile.

Once the TempTale® App opens, the app automatically connects to TempTale® Ultra BLE monitors within range and displays a list of monitor cards on the **Nearby BLE Monitors** tab (*figure 1*). View monitor data by downloading data to the TempTale® App.



figure 1 – Nearby BLE Monitors tab

Tap white card to download monitor data to app (monitor card turns blue).

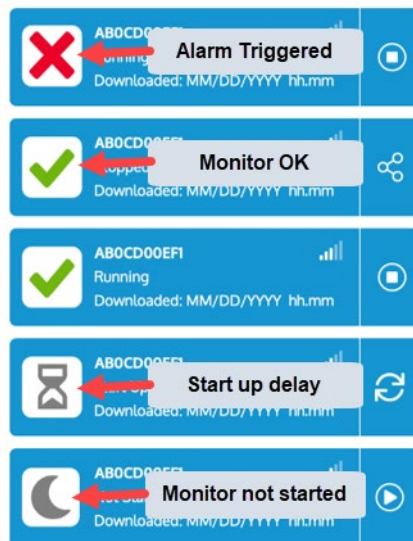

figure 2 – Monitor card Icons

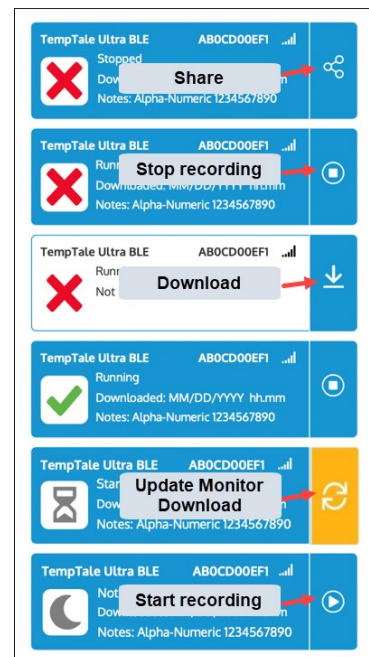

figure 3 – Monitor card Action buttons

Tap a monitor card to view its details.

figure 4 – Monitor Card Details

Nearby BLE Monitors tab Toolbar icons

	Bluetooth® – tap to return to the <i>Nearby BLE Monitors</i> tab
	NFC Scan – tap to scan NFC monitors; to download monitor data, touch phone to monitor
	Download All – tap to download multiple BLE monitors' data
	Action menu – tap to Start/Stop, Reset, Update, Export, or Delete (data from app)

Monitor card Details, Toolbar icons

	Home – tap to go to <i>My Downloads</i>
	Share – tap to Export to PDF or TTV
	Temp Graph – tap to view time/temperature details
	Delete Monitor Data from App – clears downloaded monitor data from app
	Action menu – tap to Start/Stop, Reset, Update, Export, or Delete (data from app)

Download the TempTale® Ultra BLE Monitor Data Using the TempTale® App.

Single Monitor Data Download

On the *Nearby BLE Monitors* tab, on any white monitor card, tap **Download** (figure 7).

Note: Once downloaded, the monitor card turns blue.

Multiple Monitor Data Download

- On the *Nearby BLE Monitors* tab, on the bottom toolbar, tap **Download All**.

- Select the state that you want the monitor in after download is complete:
 - Stop Monitor:** Stop recording.
 - Stop Monitor and Reset:** Stop recording and reset with same configuration (for multi-use configured monitors only).
 - Keep Monitor Running:** Continue recording.

Additional Actions

- On the bottom toolbar, tap **Actions**.

- Select **Start/Stop, Reset, Update, Export, or Delete** (removes the monitor card and its data from the app).

Export and Share the TempTale® Ultra BLE Monitor Data using the TempTale® App

To export Monitor Data, from the **Monitor Details** view:

- Tap **Share**.
- On the bottom toolbar, tap **Share**.
Share a PDF or TTV file.
- With **PDF** selected you can:
 - Scroll to tap the **Share** option: email, text, etc.

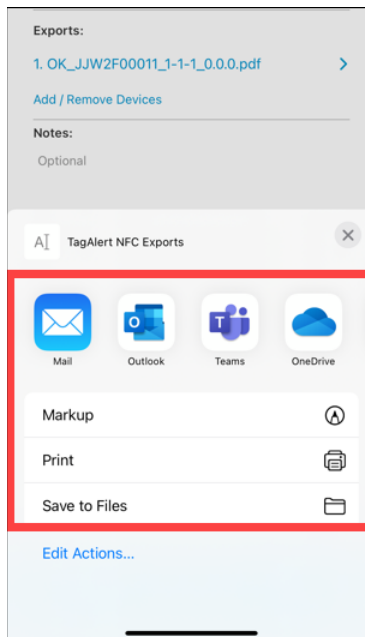
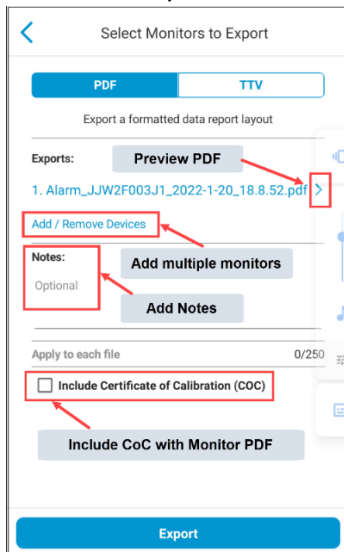

- Tap **Export**.

Note: If not stopped, monitor continues recording after Export.

Add Originator Notes (Optional, Only Before Monitor Starts Recording)

Originator Notes pass information to the Delivery Driver and the Receiver (for example, shipment tracking ID).

- Tap the white card of a *Not Started* monitor.
- Tap **Edit Note**.

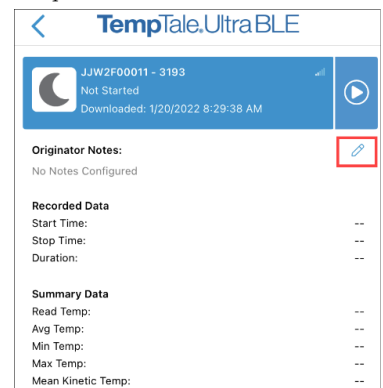

- Enter text.
- Tap **Done**.

Note: For multiple use, configured monitors, update Originator Notes before starting the next trip.

Manually Start the Monitor Recording

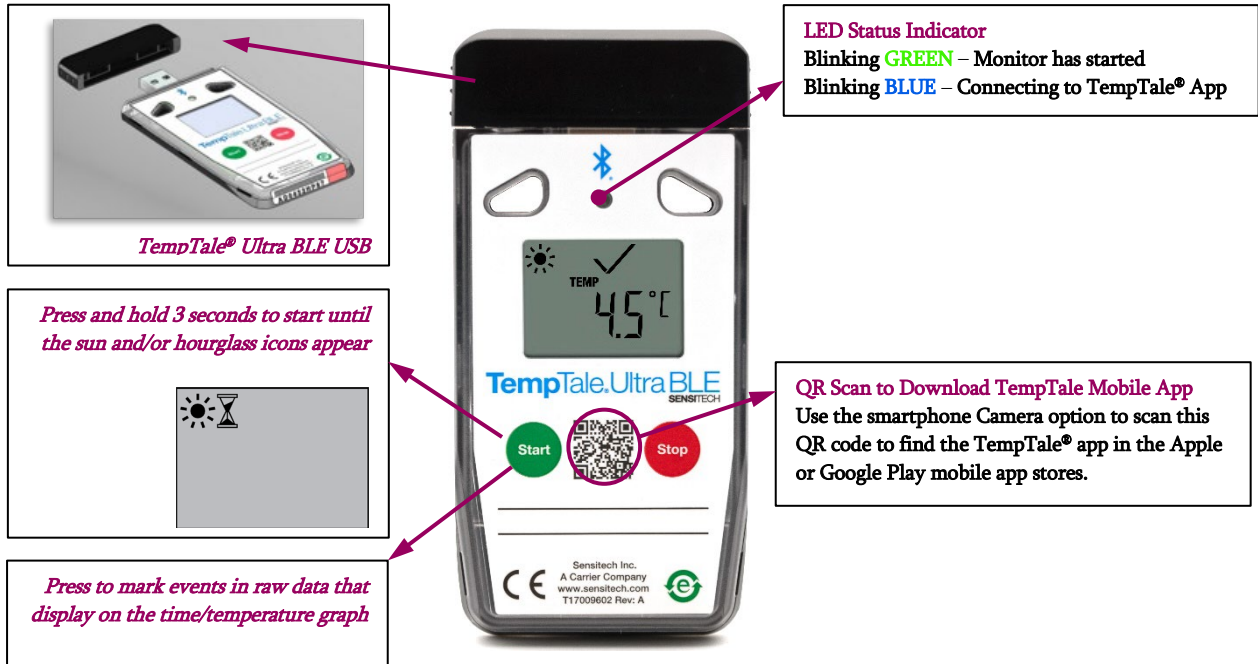
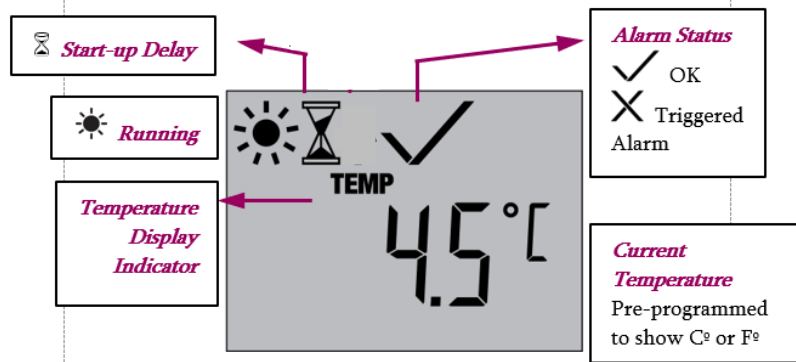

figure 5 – TempTale® Ultra BLE monitor running

Restart/Reset the Monitor from the TempTale® App (multi-use configured monitors only)

- If the monitor is running, tap the white area of the monitor card; from **Monitor Download Options**, select **Stop Monitor and Reset**.
- If the monitor is stopped, tap the blue area of the monitor card, and tap **Actions>Reset**.

Sample LCD Display Running, with no Alarm Triggered



Manually Stop the Monitor Recording

Push and hold Red Stop Button until the Stop Sign icon displays.

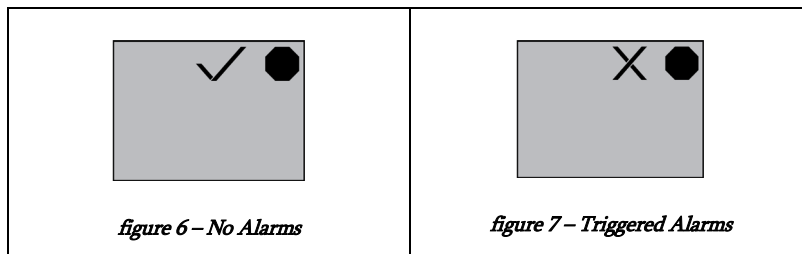

figure 6 – No Alarms

figure 7 – Triggered Alarms

Manually Reset the Monitor (multi-use configured monitors only)

1. Press and hold **Red Stop Button** on the monitor (8 seconds) until the **blinking CF** (figure 8) displays on the LCD, followed by **SEt** (figure 9).



figure 8 – CF, Ready for Configuration



figure 9 – SEt, Setup is complete

2. Release the **Stop** button; the blank LCD indicates that the monitor is reset with the same configuration and ready for use.

Bluetooth® is a registered trademark of Bluetooth SIG.